

PRISMA Base

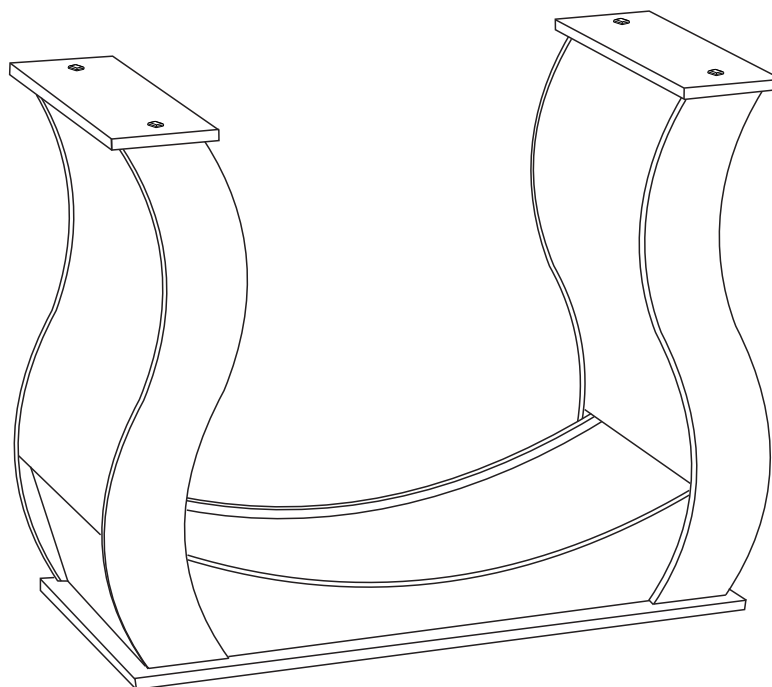

Hardware						
A		Flat head screw philips 5x50mm	04	F	Paste	
B		Pan Head Screw 4x25mm	08	G	* Allen Key	
C		Silicon	04	H	5,0x50 head 13mm	
D		Nail Shoe	04	I	Tap Hole 5mm	
E		Pin 6x40mm	08			

Hardware without scale

Note: This key does not accompany the chair hardware kit, however, it comes with the base kit.

IMPORTANT

Only parts with defects in workmanship will be replaced. For this it is necessary sending, Together with the service request, of the assembly diagram indicating the part to be replaced. All parts with service problems must be stored later returning, waiting for the authorization of shipment from the factory.

Cleaning and conservation tips

Cleaning the furniture, use a dry cloth. For more through cleaning, use a cloth Dampened with water and neutral detergent, finishing with a dry cloth.
Avoiding products with alcohol, peroba oils, wax, solvent or any other abrasive.
Avoiding excessive moisture and prolonged exposure to sunlight.



WARRANTY PRODUCT

The product has a warranty of 03 (three) months from the invoice issued.

- 01** Join the Parts 01 and 02 with screws (A), after this, fix the workpiece 03 in part 02 with screws (H) as drawing below

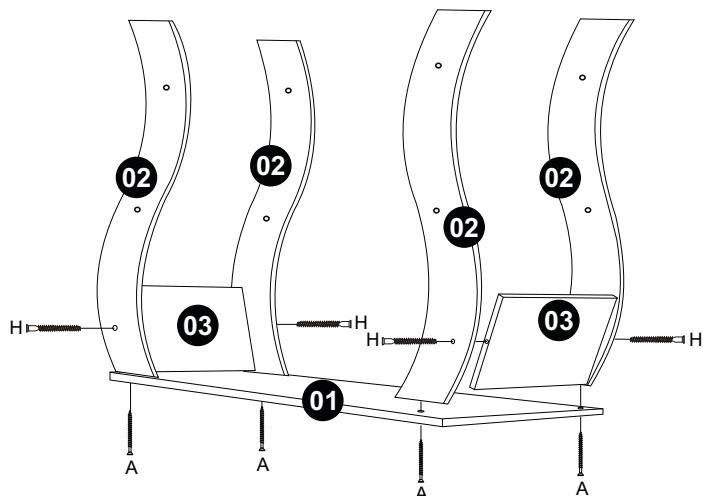

- 02** Clip the part 02 04 on each side and secure it with screws (B) according to drawing below

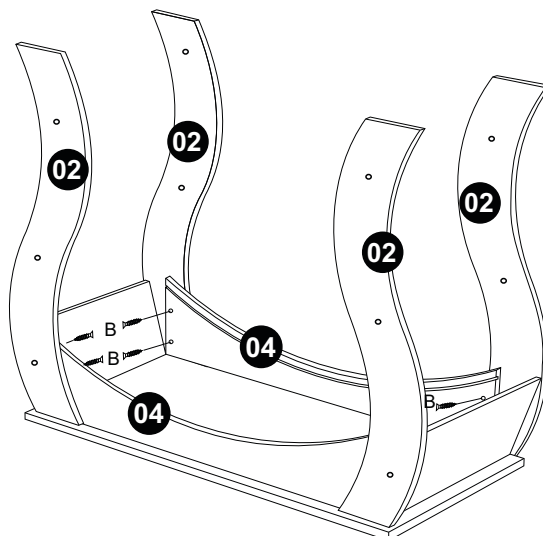

- 03** Run the workpiece 05 in 04 strips of parts according to drawing below

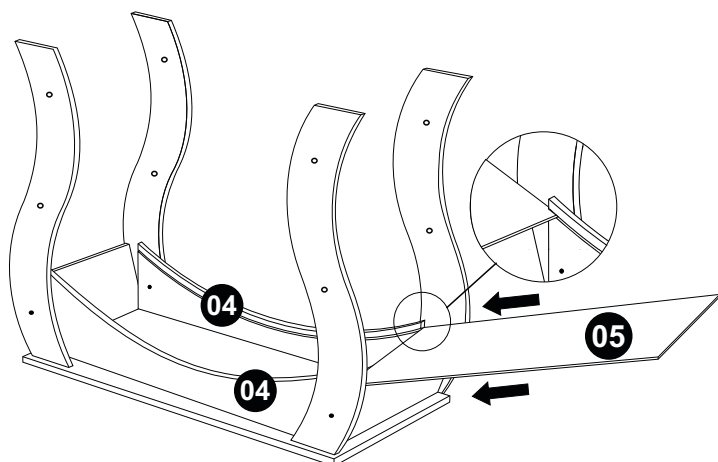

- 04** Clip the upholstered parts 06 among the 02 pieces and secure them with screws (H) as drawing below

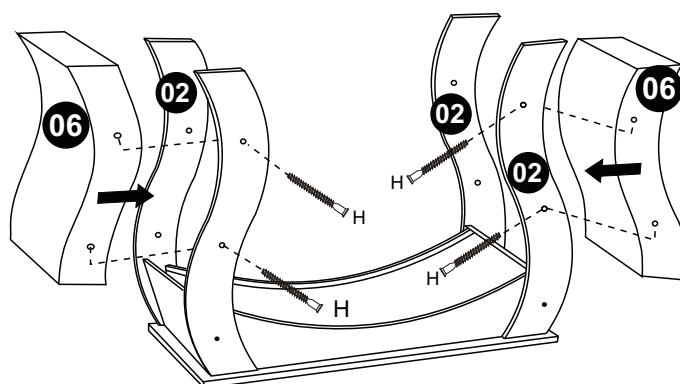

- 05** Put a drop of adhesive (F) on the side of 02 holes and secure the pins (E), then having glue on drilling heads 07 and clip the pins (E) fixed recently on the sides 02, as illustrated below.

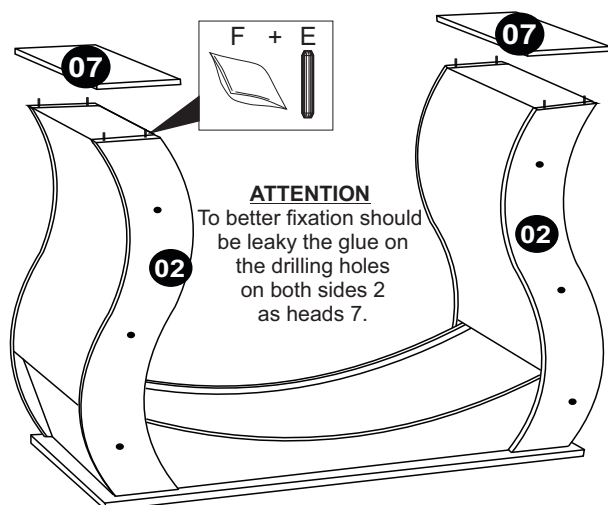

- 06** With the help of a hammer, attach the shoes with nail (D) at the bottom of the base, after that attach silicones on the Parts 07 and finally put the locket holes (I) as drawing below.

