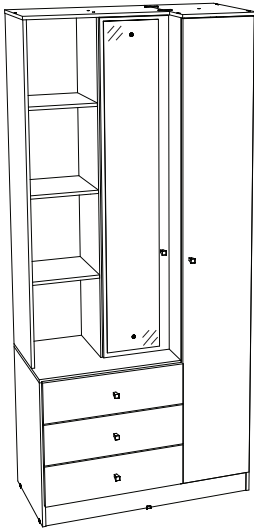
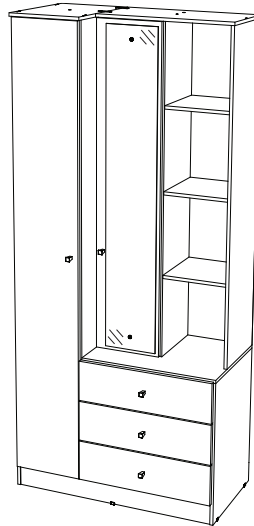

HENNInd. e Com. de Móveis Henn
Mondai - SC - Brasil

☎ +55 49 3674.3500

📷 📱 @moveishenn
www.henn.com.br**INSTRUÇÕES DE
MONTAGEM****INSTRUCCIONES DE MONTAJE
ASSEMBLY INSTRUCTIONS****ROUPEIRO MULTIUSO DOHA | ARMARIO MULTIUSO DOHA |
WARDROBE MULTIPURPOSE DOHA****D332-10 Branco****D332-129 Off White/Nature****Opção 01
Opción 01
Option 01****Opção 02
Opción 02
Option 02****AVISO**

Para limpeza de seu móvel, use uma flanela seca ou umedecida, e não utilize produtos químicos que possam danificar seu produto.

SISTEMA DE MONTAGEM

O sistema de montagem dos produtos, funciona de acordo com a ordem crescente dos números indicados no desenho. Ex: 01, 02, 03, 04... até a conclusão da montagem.

ASSISTÊNCIA TÉCNICA

Para solicitação de Assistência Técnica você consumidor deverá entrar em contato com o Lojista o qual você realizou a compra deste produto e solicitar a assistência técnica das peças avariadas. A garantia abrange todas as peças, partes e componentes que eventualmente venham apresentar defeito de fabricação no prazo de 03 (três) meses, contando a partir da entrega do produto ao consumidor, mediante nota fiscal de compra. Se houver qualquer alteração na estrutura do produto ou ocorrer defeito por negligência do montador/consumidor em relação a instrução de montagem e manuseio, não será fornecido assistência técnica gratuita.

ADVERTENCIA

Para limpieza de su móvil, use una flanela seca o húmeda, y no utilice productos químicos que puedan dañar su producto.

SISTEMA DE MONTAJE

El sistema de montaje de los productos funciona de acuerdo con el orden creciente de los números indicados en el dibujo. Ej.: 01, 02, 03, 04... hasta la conclusión del montaje.

ASISTENCIA TÉCNICA

Para solicitar Asistencia Técnica, el consumidor debe comunicarse con el Comercio que usted realizó la compra de este producto y solicita asistencia técnica para las partes dañadas. La garantía cubre todas las partes, piezas y componentes que eventualmente puedan presentar defecto de fabricación en el plazo de 03 (tres) meses, contados a partir de la entrega del producto al consumidor, mediante factura de compra. Si se produce algún cambio en la estructura del producto o se produce un defecto por negligencia del montador/consumidor en relación con las instrucciones de montaje y manipulación, no se prestará asistencia técnica gratuita.

NOTICE

To clean your furniture, use a dry or wet cloth, and do not use chemicals that may damage your product.

ASSEMBLY SYSTEM

The products' assembly system works according to the increasing order of the indicated numbers. For example: 01, 02, 03, 04 ... to the end of the assembly.

TECHNICAL ASSISTANCE

To request Technical Assistance, the consumer must contact the retailer from whom you purchased this product and request technical assistance for the damaged parts. The warranty covers all parts, parts and components that may eventually present a manufacturing defect within a period of 03 (three) months, counting from the delivery of the product to the consumer, by means of a purchase invoice. If there is any change in the structure of the product or defect occurs due to negligence of the assembler/consumer in relation to the assembly and handling instruction, free technical assistance will not be provided.

ACESSÓRIOS | ACCESORIOS | ACCESSORIES

ITM/D332-

A x36 | B x5 | C x2 | D x84 | E x85



3,5x40mm



3,5x25mm



3,5x14mm



3,5x12mm



F x97 | G x24 | H x12 | I x6 | J x10

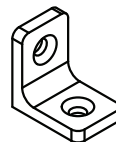
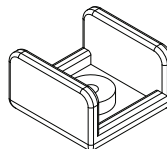
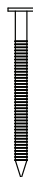
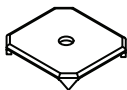

K x2 | L x2 | M x1 | N x5 | O x6

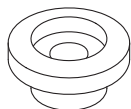

HENN

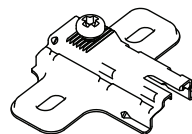
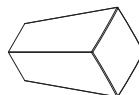

P x6 | Q x3 | R x1 | S x1 | T x48

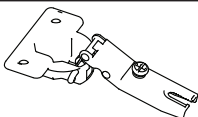

PAR

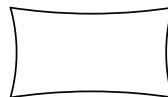

U x2

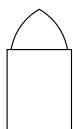

LISTA DE PEÇAS | LISTA DE PIEZAS | LIST OF PIECES

Item	Caixa Caja Box	Qtd Ctd Qty	Descrição Descripción Description	Dimensões (mm) Dimensiones (mm) Dimensions (mm)		
				Comprimento Largo Length	Largura Ancho Width	Espessura Grosor Thickness
1	2/2	1	RODAPÉ FRONTAL FALDÓN DELANTERO FRONT SKIRTING	774	73	12
2	2/2	1	RODAPÉ TRASEIRO REPOSAPIÉS TRASERO BACK FOOTBOARD	774	73	12
3	1/2	1	LATERAL ESQUERDA MENOR LADO IZQUIERDO MÁS PEQUEÑO MINOR LEFT SIDE	541	380	12
4	1/2	1	TAMPO DAS GAVETAS TAPA DE LOS CAJONES TOP OF DRAWERS	524	380	12
5	1/2	1	LATERAL ESQUERDA MAIOR LADO IZQUIERDO MÁS GRANDE BIGGER LEFT SIDE	1235	268	12
6	2/2	1	DIVISÃO MENOR DIVISIÓN MÁS PEQUEÑO MINOR DIVISION	1235	251	12
7	1/2	3	PRATELEIRA EXTERNA ESTANTE EXTERNO OUTSIDE SHELF	250	250	12
8	1/2	1	TAMPO TAPA TOP	525	268	12
9	1/2	1	DIVISÃO DIVISIÓN DIVISION	1703	380	12
10	1/2	1	BASE BASE BASE	380	262	12
11	1/2	3	PRATELEIRA MENOR ESTANTE MÁS PEQUEÑO MINOR SHELF	250	250	12
12	1/2	1	LATERAL DIREITA LADO DERECHO RIGHT SIDE	1788	380	12
13	1/2	3	PRATELEIRA ESTANTE SHELF	300	250	12
14	1/2	1	TAMPO MENOR TAPA MÁS PEQUEÑO SMALLER TOP	397	275	12
15	1/2	1	FUNDO EXTERNO FONDO EXTERNO OUTSIDE FUND	1725	263	3
16	1/2	2	FUNDO FONDO FUND	1725	263	3
17	2/2	3	FRENTE DE GAVETA FRENTE DE CAJÓN FRONT OF DRAWER	520	152	15
18	1/2	6	LADO DE GAVETA LADO DEL CAJÓN SIDE OF DRAWER	350	110	12
19	1/2	3	FUNDO DE GAVETA FONDO DE CAJÓN DRAWER BOTTOM	474	361	3
20	1/2	3	RIPA DE TRÁS MALLA DETRÁS REAR LAHT	487	110	12
21	2/2	1	PORTA PUERTA DOOR	1705	260	15
22	2/2	1	PORTA MENOR PUERTA MÁS PEQUEÑO MINOR DOOR	1230	252	15
23	2/2	1	ESPELHO ESPEJO MIRROR	1200	200	3

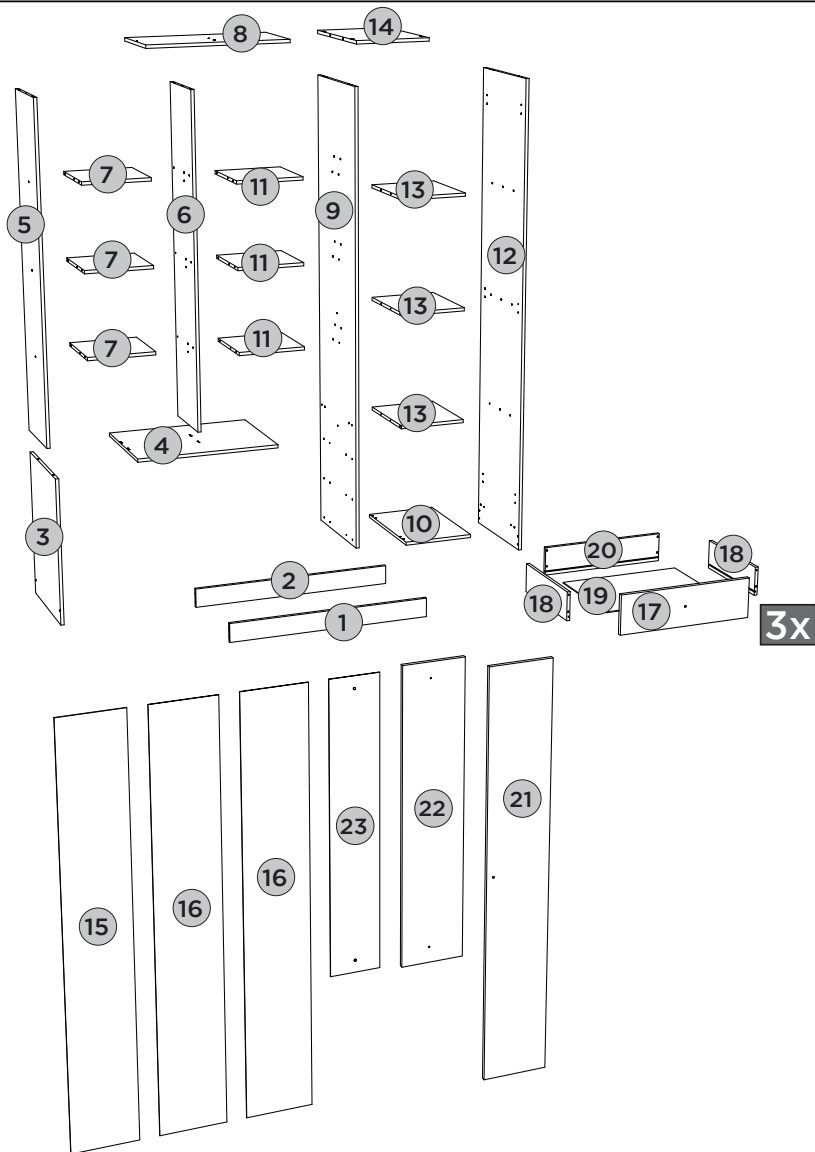

REQUISITOS PARA MONTAGEM
REQUISITOS PARA LA MONTAGE | ASSEMBLY REQUIREMENTS.

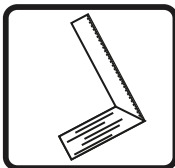
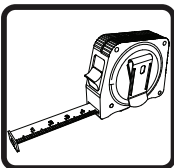
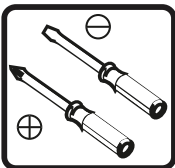
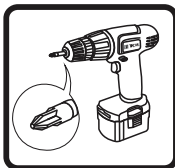

Imagens meramente ilustrativas, não acompanha o produto.
 Imágenes ilustrativas, no incluidas con el producto.
 Illustrative images, not included with the product.

PEÇAS REQUERIDAS

1	RODAPÉ FRONTAL	x1
2	RODAPÉ TRASEIRO	x1
3	LATERAL ESQUERDA MENOR	x1

ACESSÓRIOS REQUERIDOS

D		09
E		06
H		04
I		04
Q		03

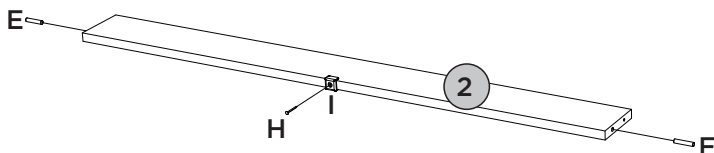
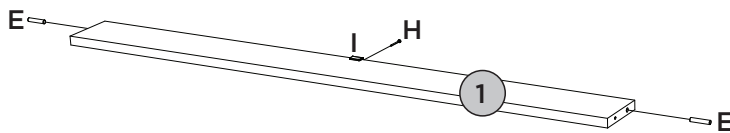
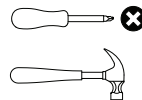
FERRAMENTAS NECESSÁRIAS

Opção 01
Opción 01
Option 01

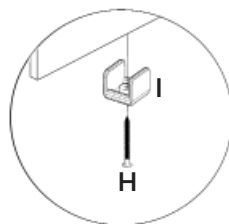
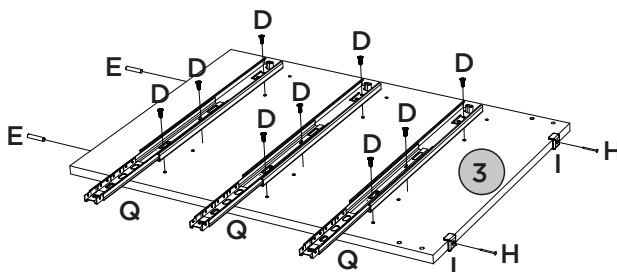

Opção 02
Opción 02
Option 02

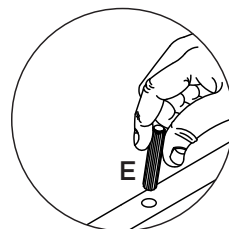
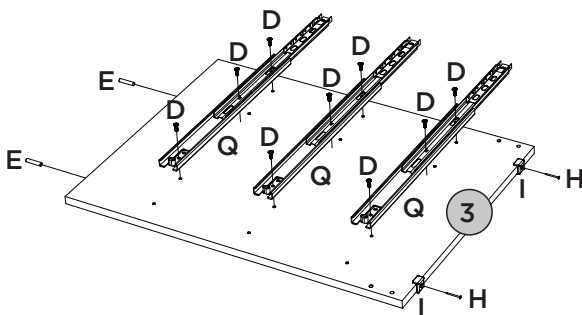

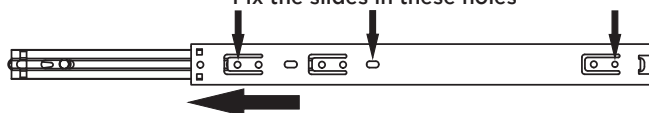

Fixar as correijas nessas furações
Fijar las diapositivas de estos agujeros
Fix the slides in these holes



PEÇAS REQUERIDAS

4	TAMPO DAS GAVETAS	x1
5	LATERAL ESQUERDA MAIOR	x1
6	DIVISÃO MENOR	x1

ACESSÓRIOS REQUERIDOS

D		06
E		10
O		03

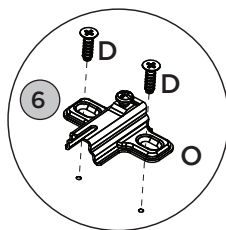
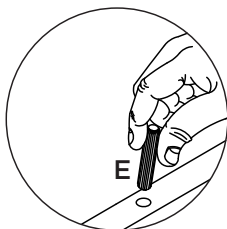
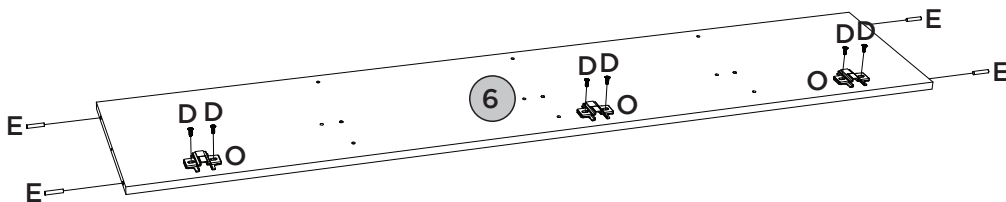
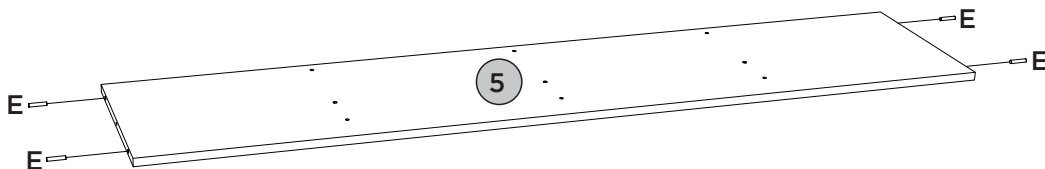
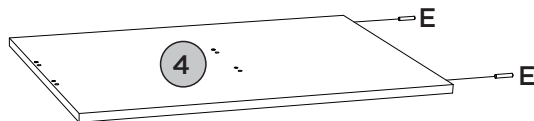
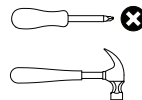
FERRAMENTAS NECESSÁRIAS

PEÇAS REQUERIDAS

7	PRATELEIRA EXTERNA	x3
8	TAMPO	x1
10	BASE	x1
11	PRATELEIRA MENOR	x3
13	PRATELEIRA	x3

ACESSÓRIOS REQUERIDOS

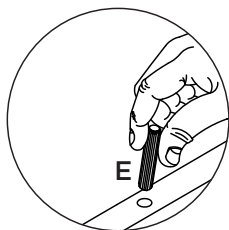
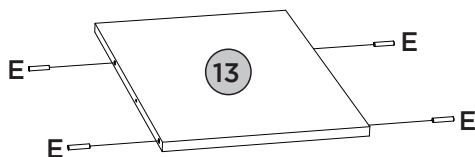
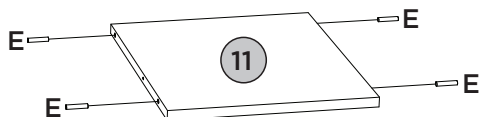
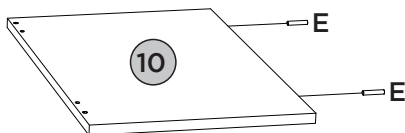
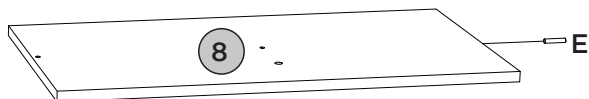
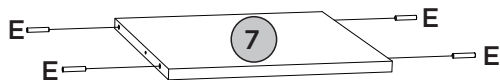
FERRAMENTAS NECESSÁRIAS

PEÇAS REQUERIDAS

9	DIVISÃO	x1
12	LATERAL DIREITA	x1

ACESSÓRIOS REQUERIDOS

D		15
E		06
H		02
I		02
O		03

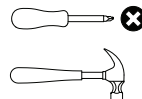
FERRAMENTAS NECESSÁRIAS

Q		03
---	--	----

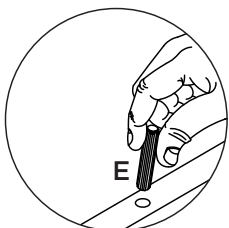

Fixar as corredeiras nessas furações
 Fijar las diapositivas de estos agujeros
 Fix the slides in these holes

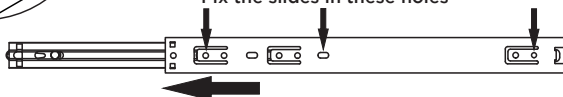

Opção 01
 Opción 01
 Option 01

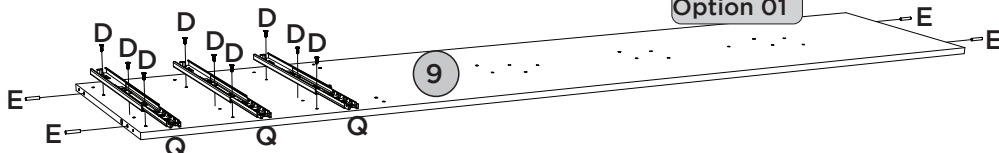

Opção 02
 Opción 02
 Option 02

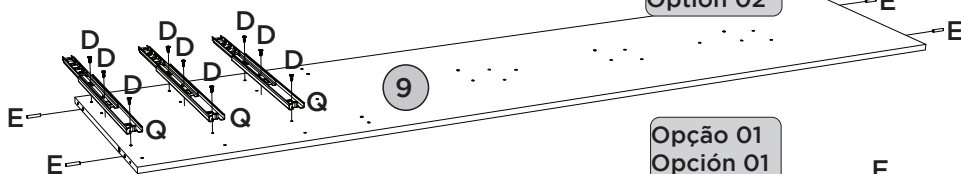

Opção 01
 Opción 01
 Option 01

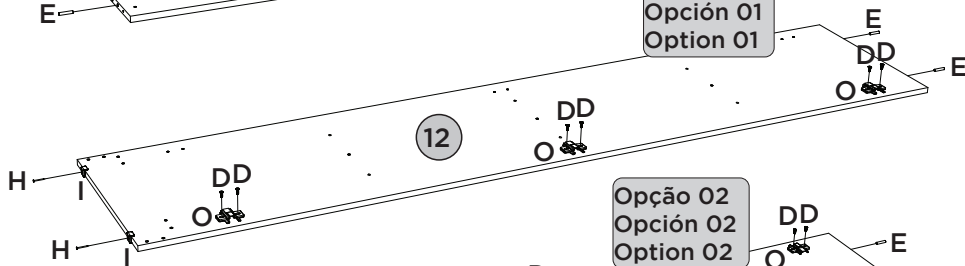

Opção 02
 Opción 02
 Option 02

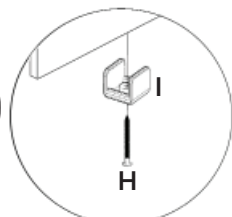
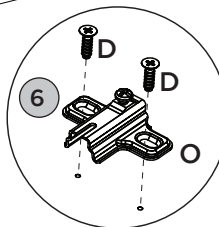
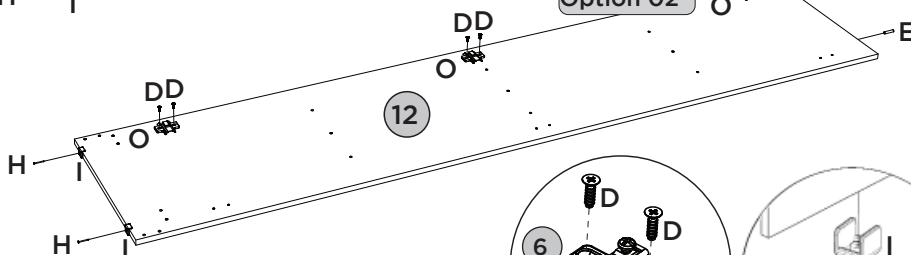

PRÉ MONTAGEM | PRE MONTAJE | PRE ASSEMBLY

ITM/D332-

PEÇAS REQUERIDAS

18	LADO DE GAVETA	x6
----	----------------	----

ACESSÓRIOS REQUERIDOS

E		24
S		

FERRAMENTAS NECESSÁRIAS

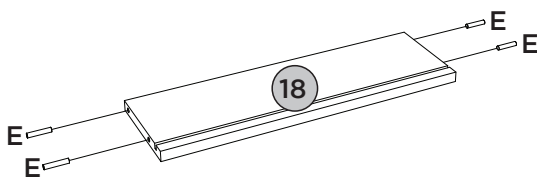
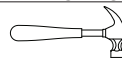





PRÉ MONTAGEM | PRE MONTAJE | PRE ASSEMBLY

PEÇAS REQUERIDAS

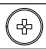
21	PORTA	x1
22	PORTA MENOR	x1
23	ESPELHO	x1

ACESSÓRIOS REQUERIDOS

C		02
D		12
L		02
P		06

FERRAMENTAS NECESSÁRIAS

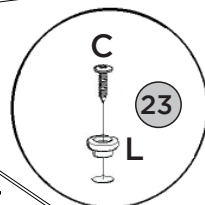
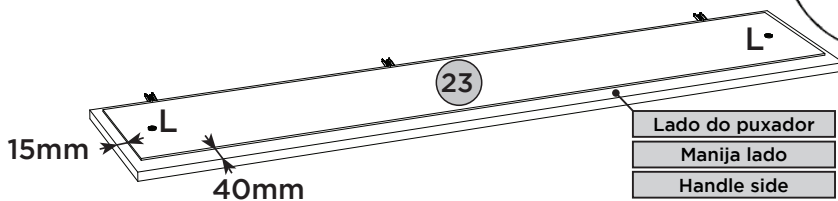
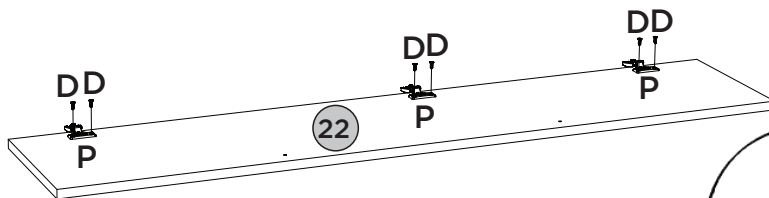
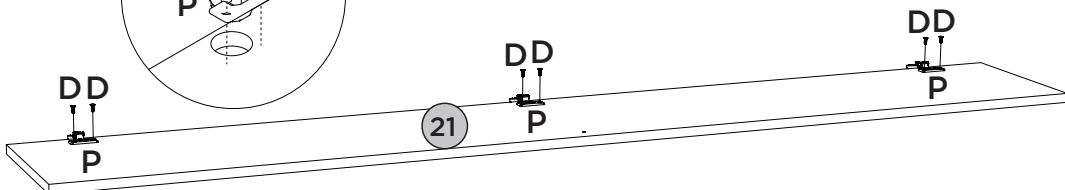
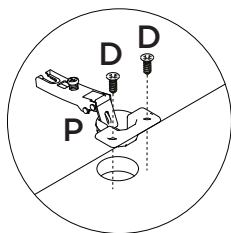
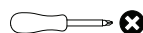

PEÇAS REQUERIDAS

1	RODAPÉ FRONTAL	x1
2	RODAPÉ TRASEIRO	x1
3	LATERAL ESQUERDA MENOR	x1

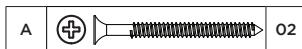
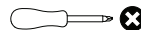
ACESSÓRIOS REQUERIDOS

FERRAMENTAS NECESSÁRIAS

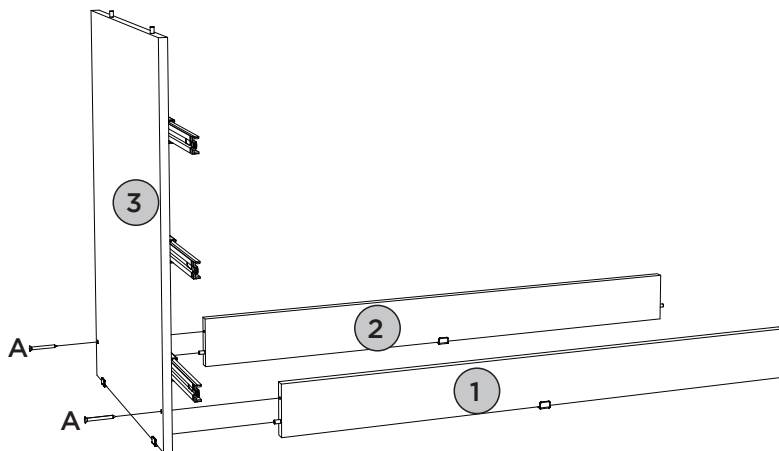
Opção 01
Opción 01
Option 01

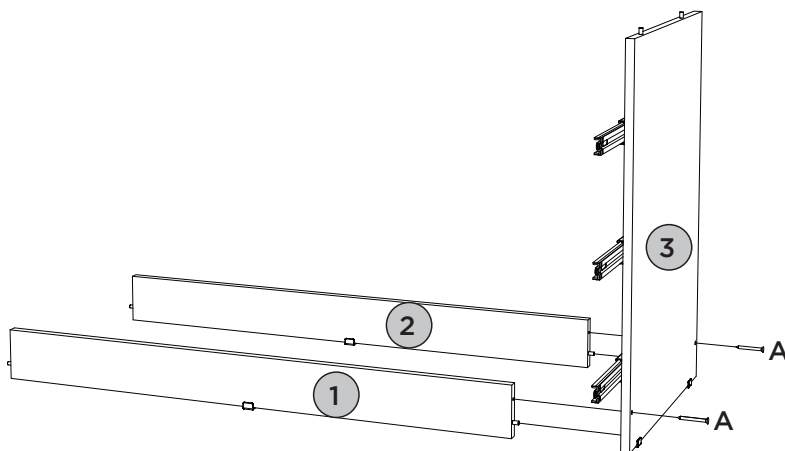

Opção 02
Opción 02
Option 02



PEÇAS REQUERIDAS

4	TAMPO DAS GAVETAS	x1
5	LATERAL ESQUERDA MAIOR	x1
6	DIVISÃO MENOR	x1
7	PRATELEIRA EXTERNA	x3

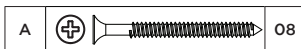
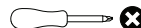
ACESSÓRIOS REQUERIDOS

FERRAMENTAS NECESSÁRIAS

Opção 01
Opción 01
Option 01



Fazer a furação passante para a colocação da cavilha (E) nas pré marcações destacadas.

Haz el agujero pasante para colocar el pin (E) en las premarcas resaltadas.

Drill the through hole to place the dowel (E) in the highlighted pre-markings.

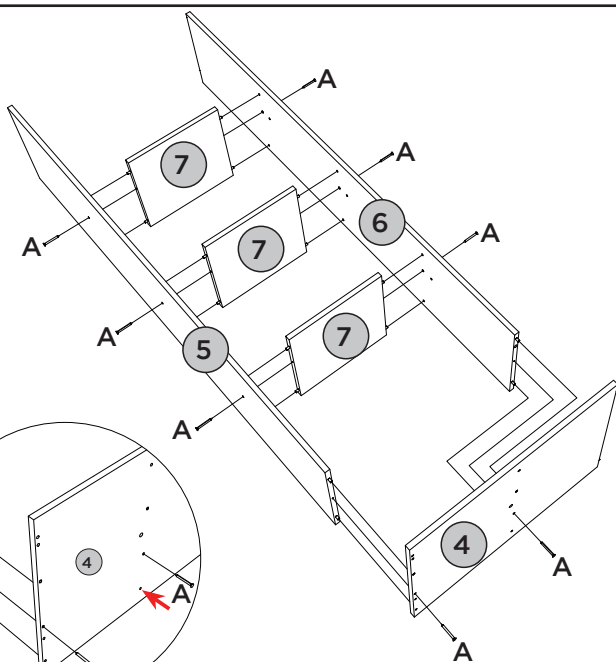
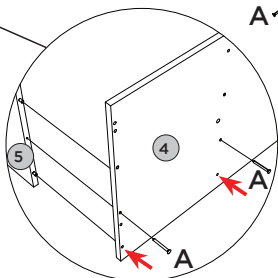

Opção 02
Opción 02
Option 02

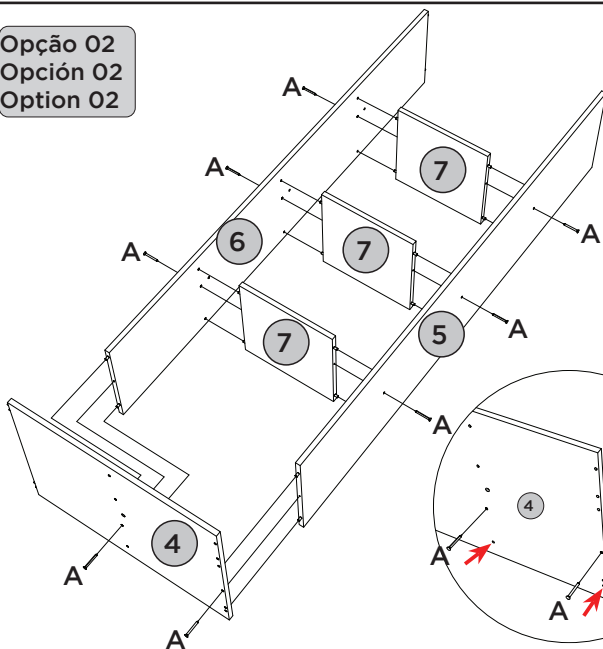

Fazer a furação passante para a colocação da cavilha (E) nas pré marcações destacadas.





Haz el agujero pasante para colocar el pin (E) en las premarcas resaltadas.

Drill the through hole to place the dowel (E) in the highlighted pre-markings.

PEÇAS REQUERIDAS

8	TAMPO	x1
---	-------	----

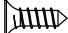
ACESSÓRIOS REQUERIDOS

A			02
D			04
J			02

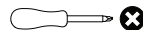
FERRAMENTAS NECESSÁRIAS

Opção 01
Opción 01
Option 01

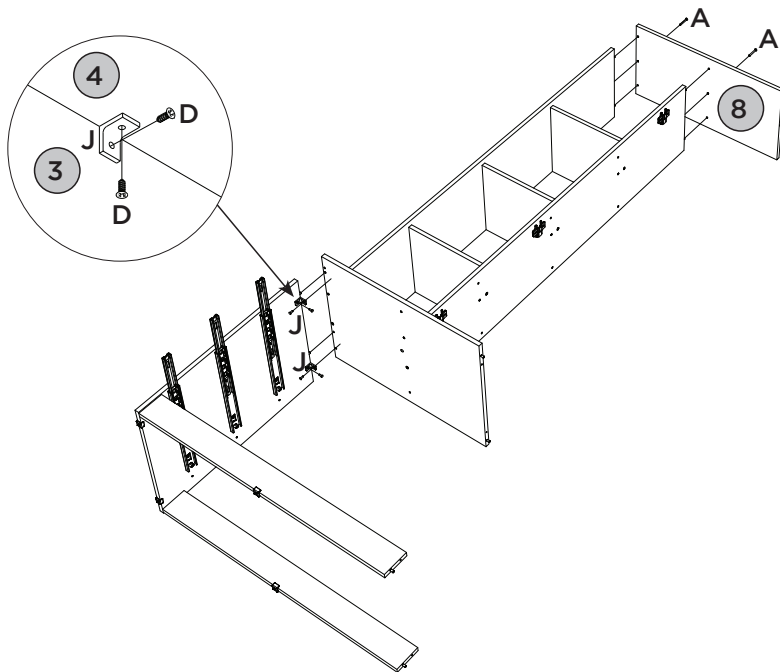

Opção 02
Opción 02
Option 02

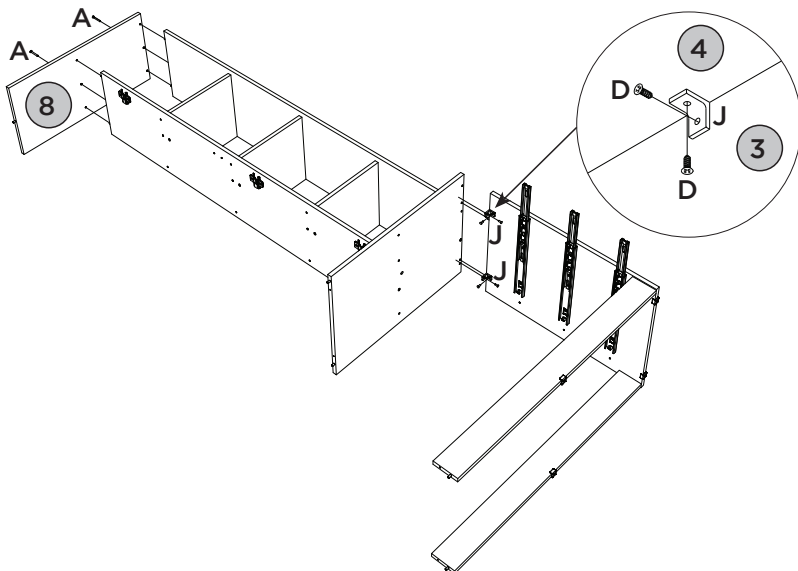

PEÇAS REQUERIDAS

9	DIVISÃO	x1
10	BASE	x1

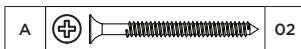
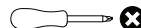
ACESSÓRIOS REQUERIDOS

FERRAMENTAS NECESSÁRIAS

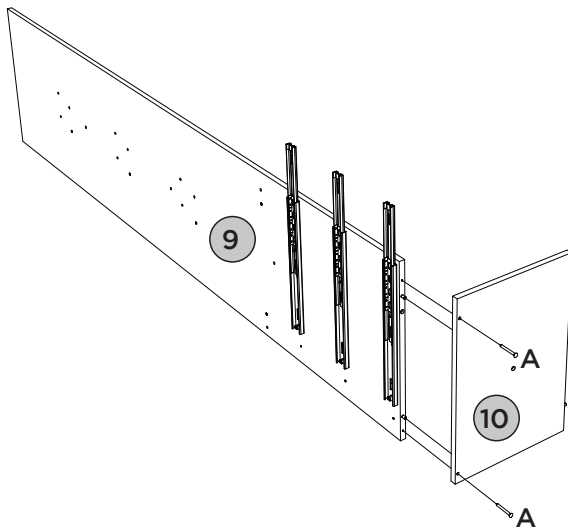
Opção 01
Opción 01
Option 01

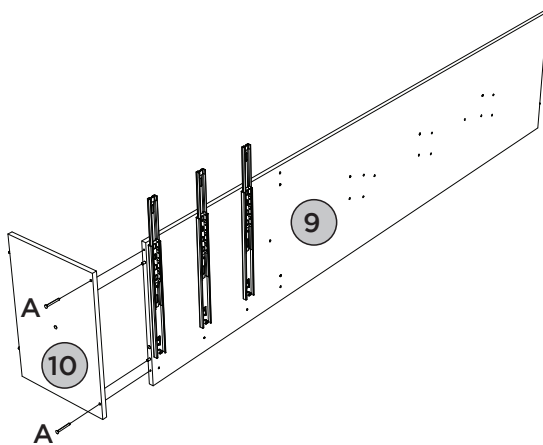

Opção 02
Opción 02
Option 02



PEÇAS REQUERIDAS

11	PRATELEIRA MENOR	x3
----	------------------	----

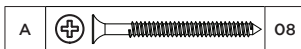
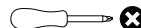
ACESSÓRIOS REQUERIDOS

FERRAMENTAS NECESSÁRIAS

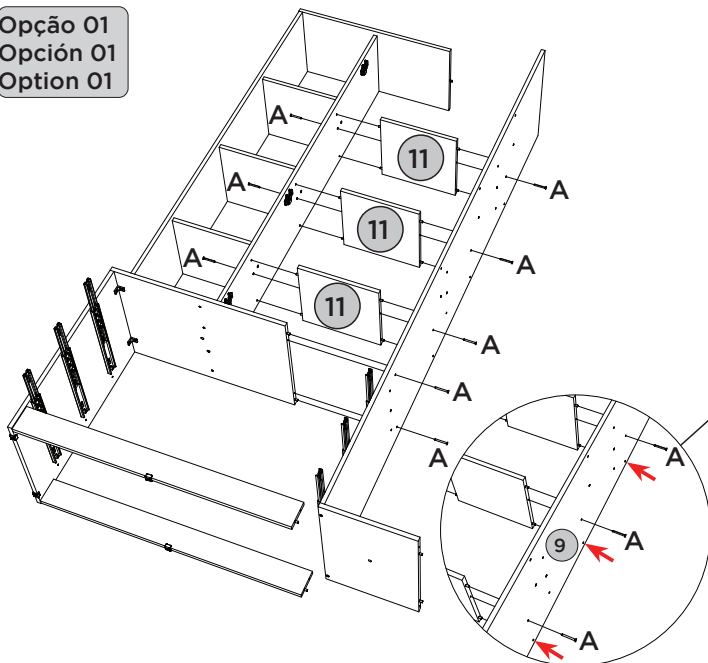
Opção 01
Opción 01
Option 01



Fazer a furação passante para a colocação da cavilha (E) nas pré marcações destacadas.

Haz el agujero pasante para colocar el pin (E) en las premarcas resaltadas.

Drill the through hole to place the dowel (E) in the highlighted pre-markings.

Opção 02
Opción 02
Option 02



Fazer a furação passante para a colocação da cavilha (E) nas pré marcações destacadas.

Haz el agujero pasante para colocar el pin (E) en las premarcas resaltadas.

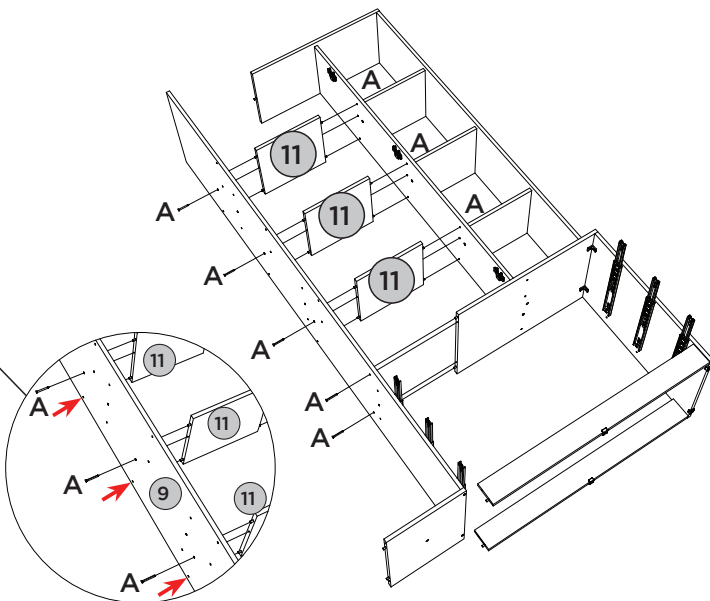

Drill the through hole to place the dowel (E) in the highlighted pre-markings.



PEÇAS REQUERIDAS

12	LATERAL DIREITA	x1
13	PRATELEIRA	x3
14	TAMPO MENOR	x1

ACESSÓRIOS REQUERIDOS

A		14
D		04
J		02

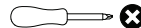
FERRAMENTAS NECESSÁRIAS

Opção 01
Opción 01
Option 01

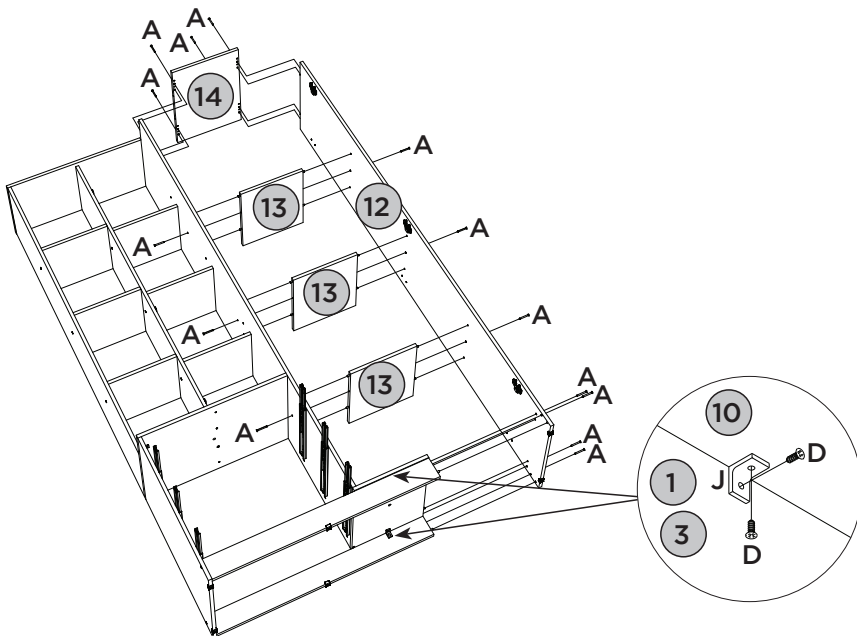

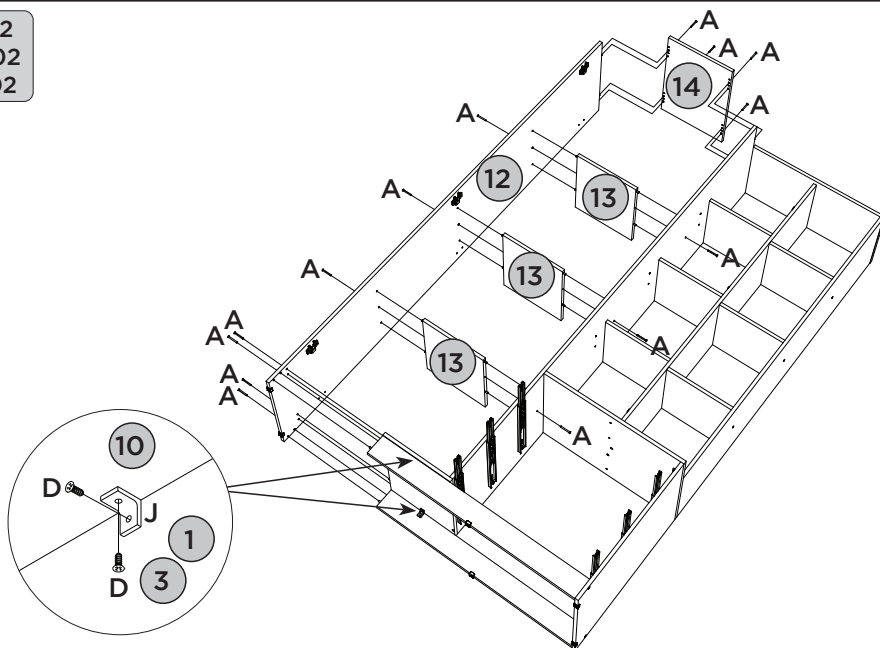

Opção 02
Opción 02
Option 02



PEÇAS REQUERIDAS

15	FUNDO EXTERNO	x1
16	FUNDO	x2

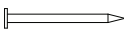
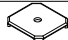
ACESSÓRIOS REQUERIDOS

D		04
F		97
G		24
K		02
R		01

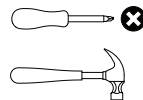
FERRAMENTAS NECESSÁRIAS

Opção 01
Opción 01
Option 01

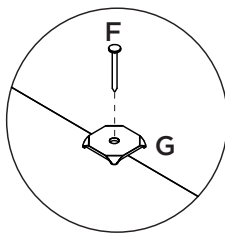
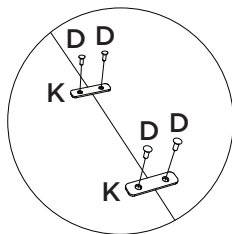

Opção 02
Opción 02
Option 02

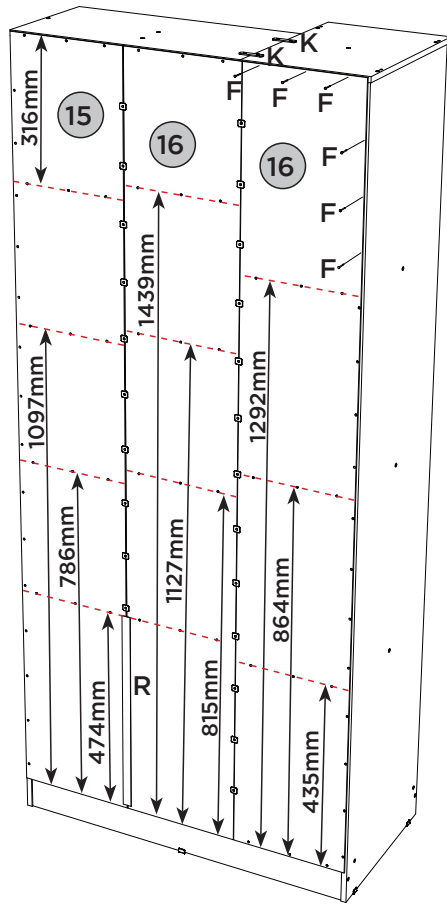
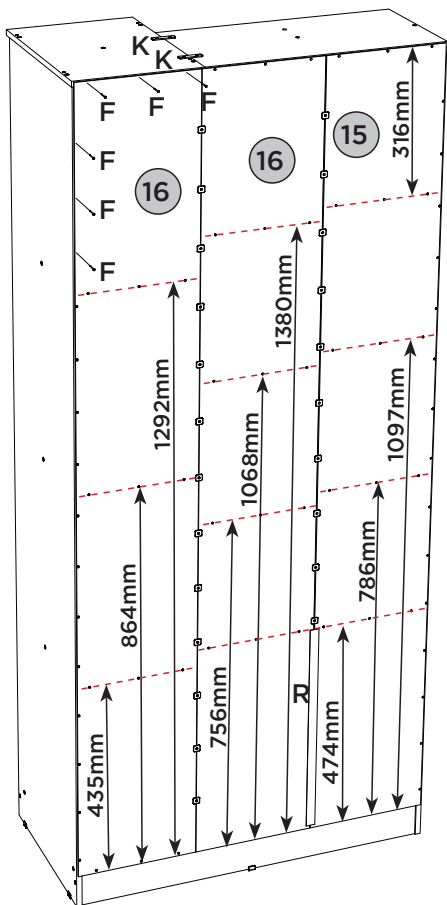

PEÇAS REQUERIDAS

17	FRENTE DE GAVETA	x3
18	LADO DE GAVETA	x6
19	FUNDO DE GAVETA	x3
20	RIPA DE TRÁS	x3

ACESSÓRIOS REQUERIDOS

B		03
D		30
H		06
J		06
N		03

FERRAMENTAS NECESSÁRIAS

Q		03
S		

3x

1º

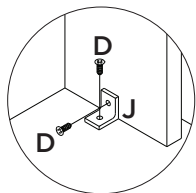
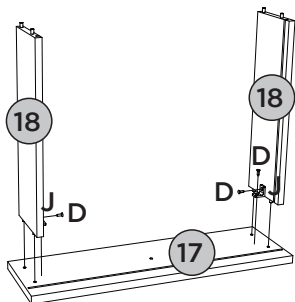
3x

2º

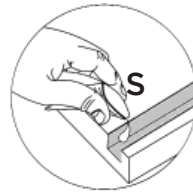
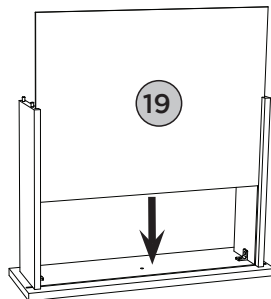
3x

3º

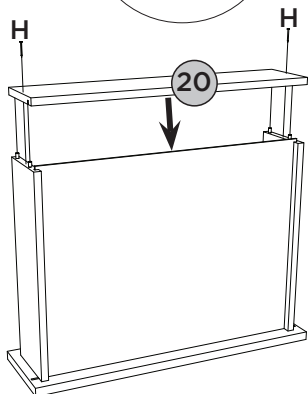
3x

4º

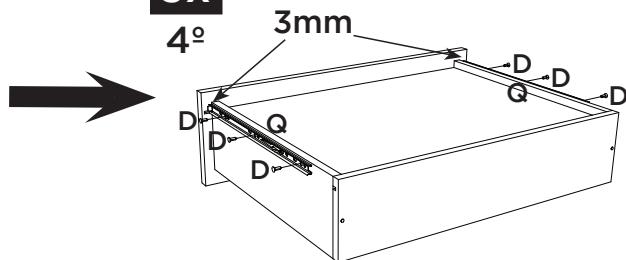
3x

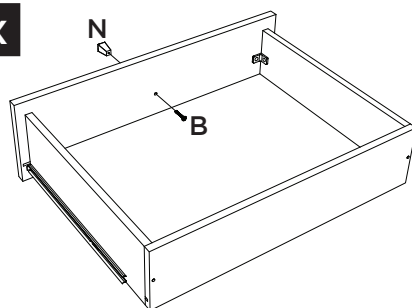

5º



PEÇAS REQUERIDAS

21	PORTA	x1
22	PORTA MENOR	x1
23	ESPELHO	x1

ACESSÓRIOS REQUERIDOS

B		02
N		02

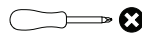
FERRAMENTAS NECESSÁRIAS

Para porta (22): fazer furação passante para puxador (N)

Para la puerta (22): hacer agujeros pasantes para la manija (N)

For door (22): make through holes for handle (N)

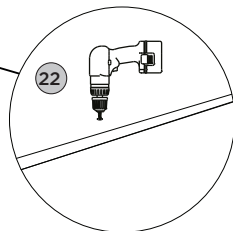

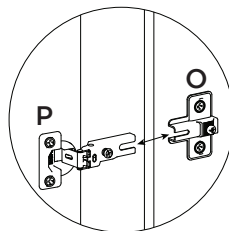
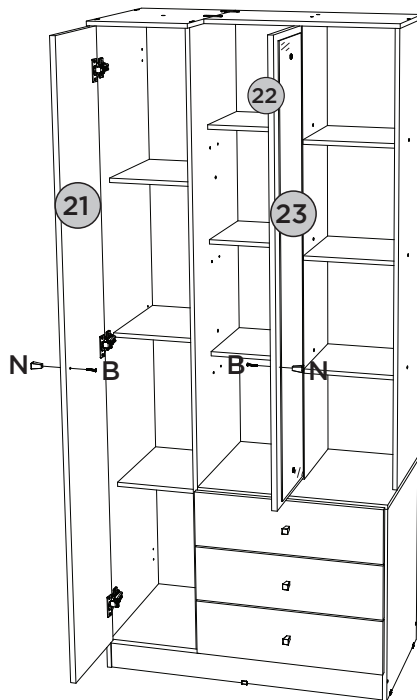
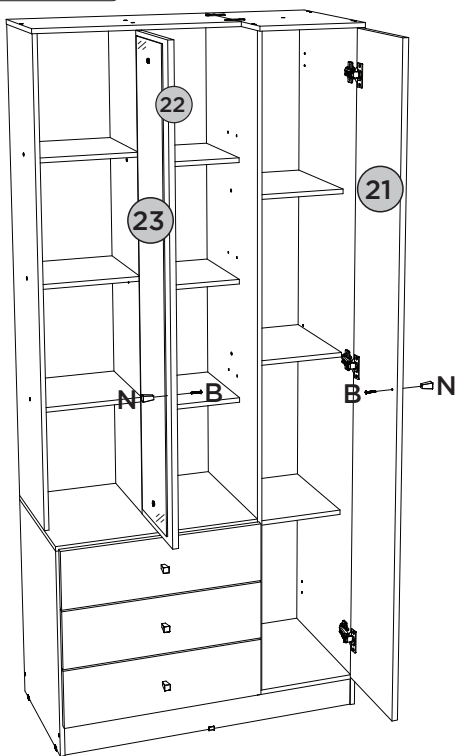

Opção 01
Opción 01
Option 01

Opção 02
Opción 02
Option 02

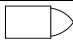

ACESSÓRIOS REQUERIDOS

T		48
U		02
V		01

Pesos máximos recomendados com carga distribuída
 Peso máximo recomendado con la carga distribuida
 Recommended maximum weight with distributed load.

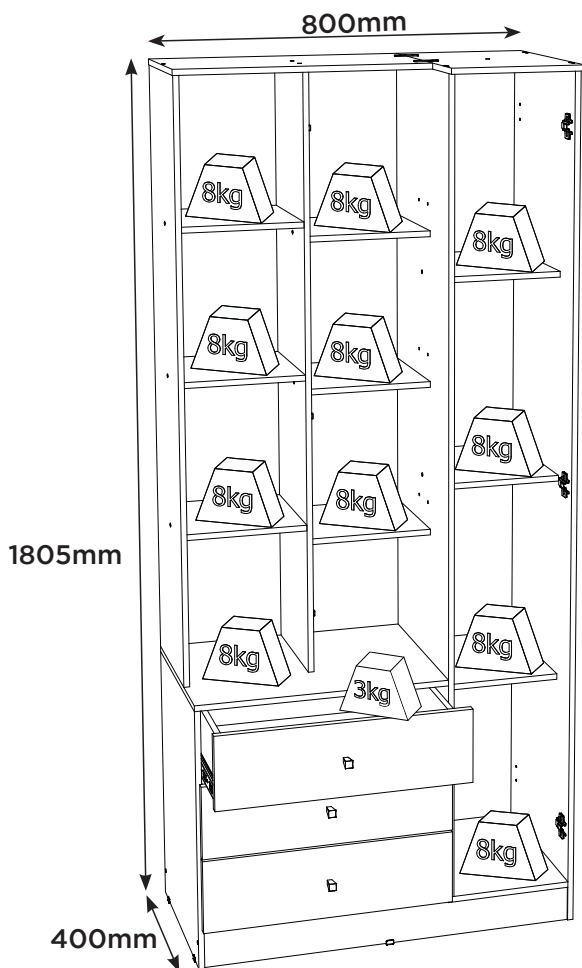

PERFECT CORRECTION
 CORRECCIÓN PERFECTA

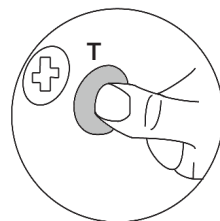
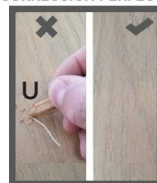

PRODUTO CONCLUÍDO
PRODUCTO TERMINADO
FINISHED PRODUCT

